



20

**BUILT TO LAST:
20-YEAR
PRODUCT WARRANTY**



350 - 360 Wp 132 MONOCRYSTALLINE HALF-CUT CELLS

AEG solar modules combine the most advanced technology with high reliability in manufacture to offer you a product meant for high achievements.



OPTIMIZED DESIGN MAXIMUM EFFICIENCY

The AEG solar module AS-M1322B with half-cut cell technology is designed to minimize cell-to-module power losses, boosting the performances of your installation



FULL BLACK, PREMIUM LOOK

The careful selection of components (cells, backsheet and frames) ensures a premium product look and provides extra aesthetical value

COMPREHENSIVELY CERTIFIED

AEG solar modules and production facilities are compliant with the the latest standards to guarantee safety and reliability. Production facilities are certified according to ISO 9001, ISO 14001 and OHSAS 18001. AEG solar products are certified among others by:



YOUR ADVANTAGE AT A GLANCE

Premium solar panel with quality components
High efficiency - up to 360 Wp
Product compliant with IEC 61215, IEC 61730
20 years Product warranty
25 years linear Power warranty

www.aeg-industrialsolar.de



ELECTRICAL CHARACTERISTICS AT STC¹

		AS-M1322B-H-350	AS-M1322B-H-355	AS-M1322B-H-360
Nominal Power (P _{max})	[Wp]	350	355	360
Power Sorting ²	[Wp]	-0 / +5	-0 / +5	-0 / +5
Maximum Power Voltage (V _{mp})	[V]	36.83	37.01	37.19
Maximum Power Current (I _{mp})	[A]	9.51	9.60	9.69
Open Circuit Voltage (V _{oc})	[V]	45.34	45.50	45.66
Short Circuit Current (I _{sc})	[A]	9.90	9.99	10.08
Module Efficiency (η _m)		18.84%	19.11%	19.38%
Maximum System Voltage	[V]	1000	1000	1000
Series Fuse Maximum Rating	[A]	20	20	20

MECHANICAL CHARACTERISTICS

Solar cells	132 (6 x 22) monocrystalline silicon, 158.75 x 79.37 mm half-cut cells
Front glass	3.2 mm (0.13") high-transparency AR coating glass
Backsheet	Black backsheet
Encapsulant	EVA (Ethylene-Vinyl Acetate)
Frame	Anodized aluminum alloy, black
Junction box	IP67/IP68 rated, 3 bypass diodes
Cables	UV resistant cable 1000 mm (39.3"), sec.4.0 mm ²
Connectors	MC4 compatible connectors
Dimensions	1854 mm x 1002 mm x 35 mm (74.1" x 39.4" x 1.37 ")
Weight	21 kg (46.3 lbs)
Maximum load	Wind: 2400 Pa / Snow: 5400 Pa

TEMPERATURE CHARACTERISTICS

NOCT	42°C ± 3°C
P _{max} Temp. Coefficient (γ)	-0.365 %/°C
V _{oc} Temp. Coefficient (β)	-0.270 %/°C
I _{sc} Temp. Coefficient (α)	0.038 %/°C
Operating temperature	-40°C to + 85°C

PACKING CONFIGURATION

Packing configuration	31 pcs / pallet
Loading capacity	744 pcs / 40 ft HC

TECHNICAL DRAWINGS

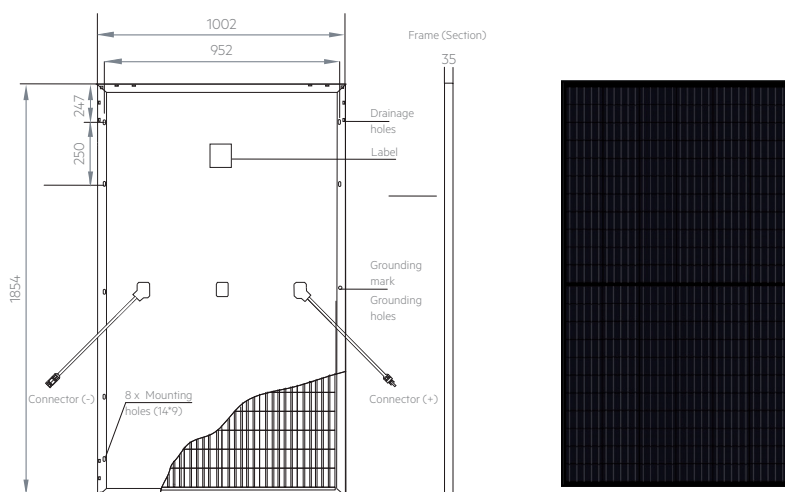

Module dimensions in the technical picture are expressed in mm with tolerance +2 mm (+0.079 ")

1- Standard Test Conditions (STC): Irradiance 1000 W/m², Air Mass AM = 1.5, Cell Temperature 25°C, Tolerance on P_{max} = 3%, Tolerance on V_{oc} = 3%, Tolerance on I_{sc} = 4%

2- AEG photovoltaic modules are classified according to a principle of positive power tolerance: the Power Output measured at STC of the delivered modules exceeds their assigned Nameplate Nominal Power at STC within a power tolerance range between -0 Wp and +5 Wp.

3- Normal Operating Cell Temperature (NOCT): Irradiance 800 W/m², Wind Speed 1m/s, Ambient Temperature 20°C, Power measurement uncertainty within ± 3%.

4- No less than 97% of the minimum "Peak Power at STC" in the first year, power output decline no more than 0.7% per year thereafter. Full text of the Warranty Terms available at: www.aeg-industrialsolar.de

© Solar Solutions GmbH. Specifications in this datasheet are subject to change without notice. Code: AS-M1322B-H-M&N1-SBB 350-360 version 202001V2EN-VDH

AEG is a registered trademark used under license from AB ElectroLux (publ).

WARRANTIES

Product warranty	20 years
Performance warranty	25 years, linear ²

I-V CURVES / IRRADIANCES

